

# Wibbow

## Brick DC-DC Converter (2nd Gen) Brochure



High power



High power density



Low EMI



Parallel



A-Full Brick  
[117 x 55.9 x 12.7mm]

C-Quarter Brick  
[57.9 x 36.8 x 12.7mm]

B-Half Brick  
[57.9 x 55.9 x 12.7mm]

Wibbow International Co., Limited

## DC-DC Converters

Achieve China's only in-situ replacement



### Compatibility and Interchangeability

Pin-to-pin compatible and interchange with VICOR products;



### Autonomous and Controllable

100% localization of DTI;



### High Efficiency

5%-7% higher efficiency than VICOR products;



### Appraisal

The products have passed the appraisal and inspection of CEPREI;



### High Reliability

Digital isolation technology and higher reliability than optoisolator module;



Full Brick

**100%**  
From China



Half Brick



Quarter Brick

## DC-DC Converters

### **ADVANTAGES 1** In-situ replacement



#### Same Size

Consistent overall dimensions and pin definitions



#### Same Parameter

Exactly the same up-and-down parameters



#### Interchangeable

Pulse frequency modulation and mixed insertion



#### Smartest

Remote control and alarm



#### Direct Plugging

Plugging without making changes



## DC-DC Converters

### ADVANTAGES 2 Higher efficiency and lower loss

#### Higher Efficiency

- 7% higher efficiency than similar VICOR products, and efficiency up to 95%;
- 100W higher full brick output power than similar VICOR products;
- Flatter efficiency curve in the range of full input voltage and output load;

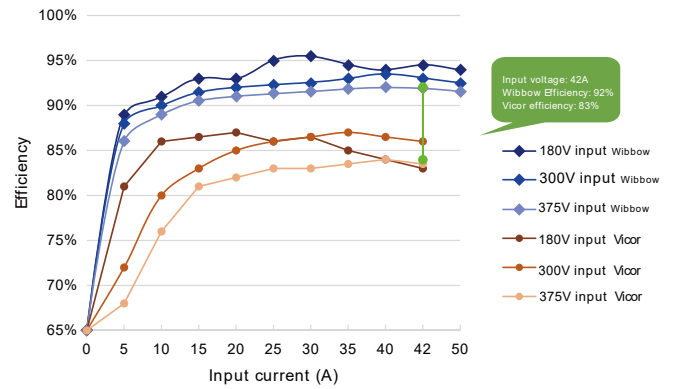

#### Lower Loss

- Lower power consumption, less than 1/2 of similar VICOR products;

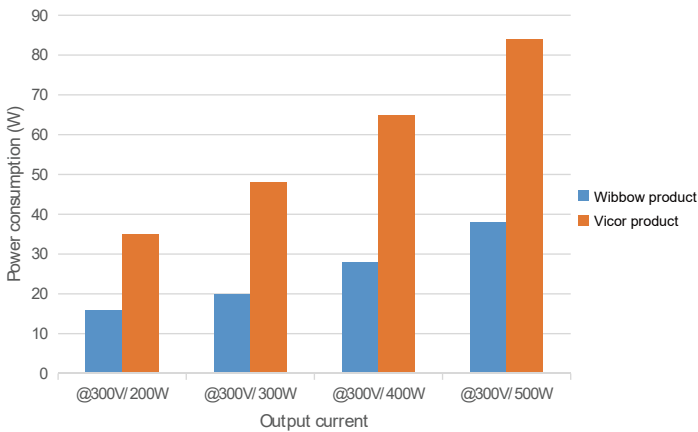

## DC-DC Converters

**ADVANTAGES 3** Complete series  
12 series 252 models

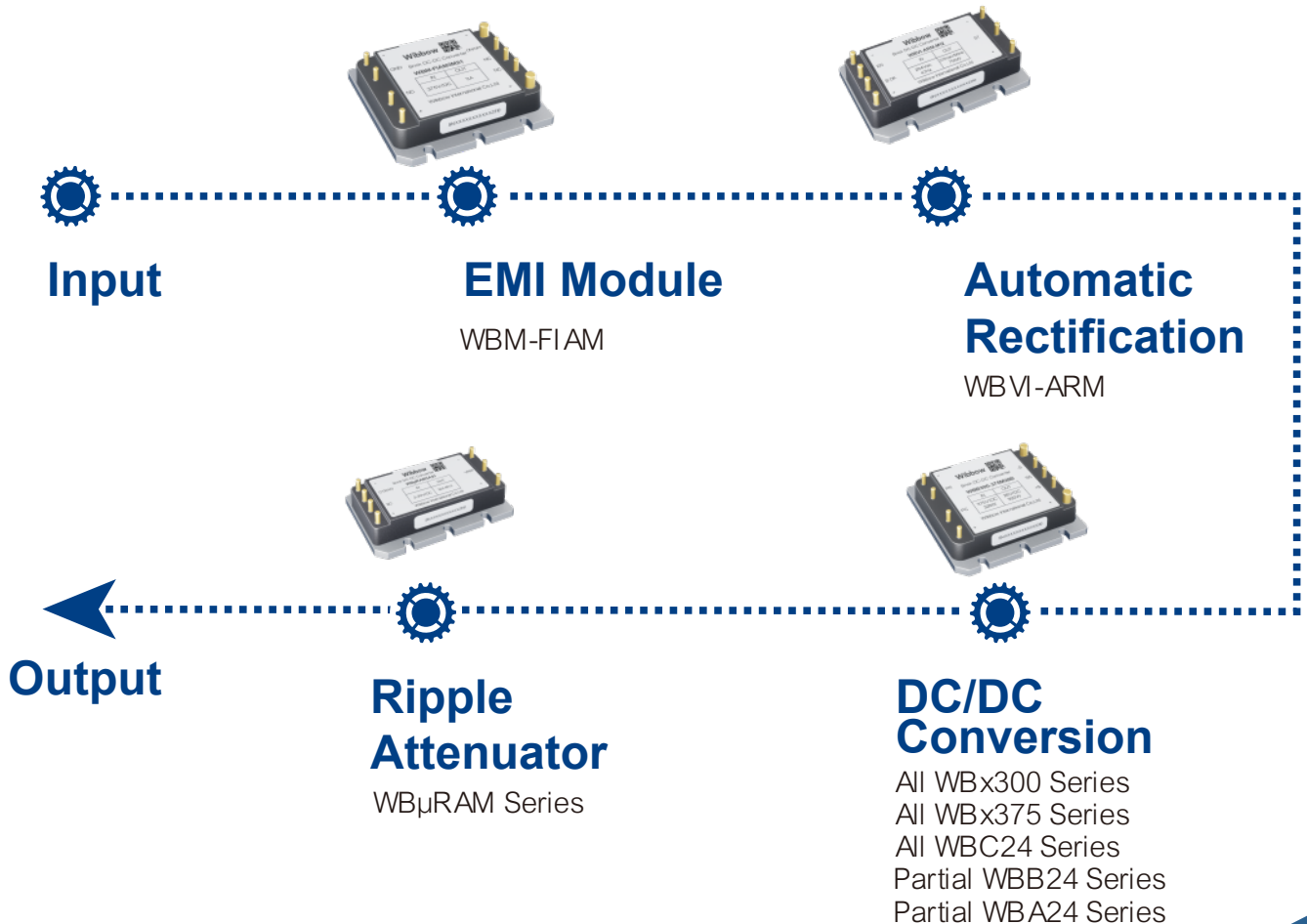

## DC-DC Converters

### **ADVANTAGES 4** Dedicated production line

Annual production of 300,000 pieces in stable supply

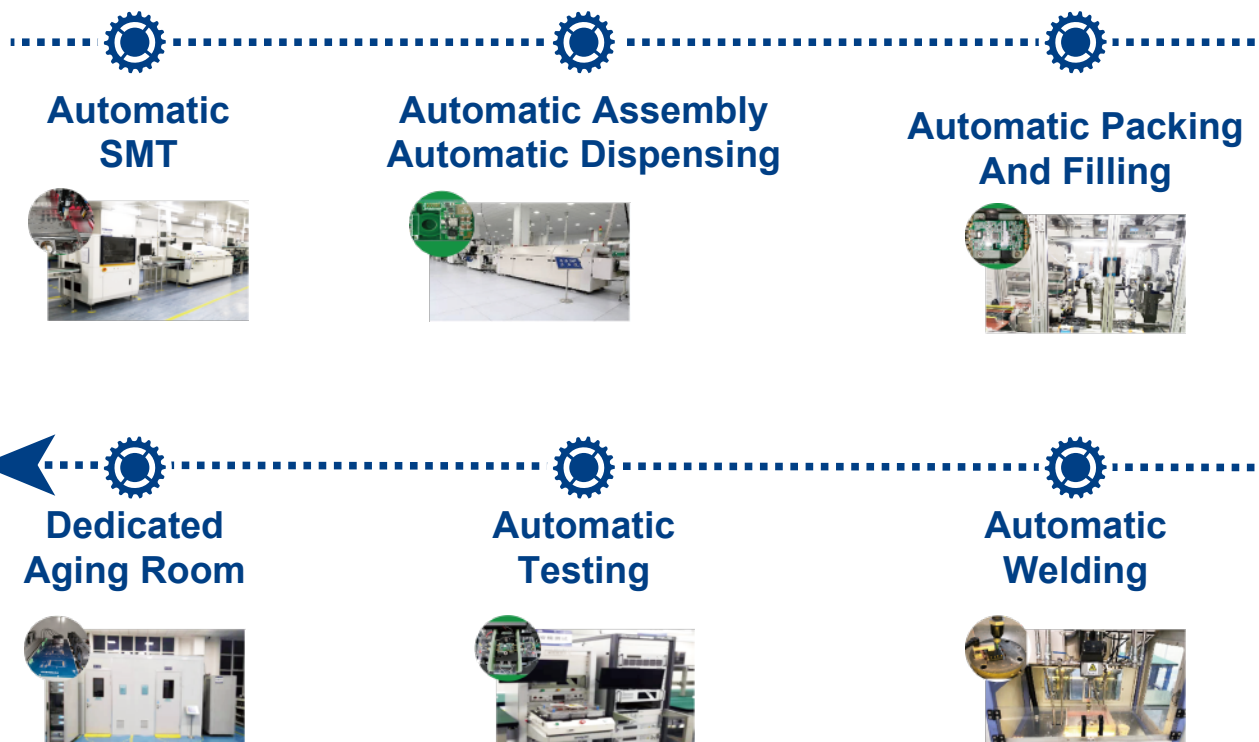

## Introduction to Brick DC-DC Converters (2nd Gen)

With high efficiency, high reliability and parallelling, the Brick DC-DC Converter is based on the patented PFM control circuit topology and embedding with silicone rubber sealed by metal base and plastic cavity, providing high-efficiency and highreliability DC/DC conversion output. It is completely compatible with the same series from Vicor and supports mixed insertion without changing any periphery parameters for replacement, ensuring easy use and providing about 5% higher conversion efficiency than the same series of Vicor; and the series also have comprehensive protections (against input over-voltage and under-voltage, output over-voltage, over-current, short circuit and over-temperature), enable control and fault monitoring functions. The product design and manufacture comply with GJB10164-2021 , and are ideally for onboard, missile-borne, vehicle-mounted, ship-based electronic systems, TR components and other highly reliable electronic systems.

### Product series

Product Series	Input Voltage	Output Voltage	Output Power	Parallel	Electrical Characteristics	Package Size(mm)	Page
WBC24	18~40V	3.3~48V	75~150W	Supported	Isolated, Regulated	57.9x36.8x12.7	2
WBB24	18~40V	3.3~48V	150~350W	Supported	Isolated, Regulated	57.9x55.9x12.7	3
WBA24	18~40V	3.3~48V	300~500W	Supported	Isolated, Regulated	116.8x55.9x12.7	4
WBC300	180~375V	3.3~48V	75~150W	Supported	Isolated, Regulated	57.9x36.8x12.7	5
WBB300	180~375V	3.3~48V	150~250W	Supported	Isolated, Regulated	57.9x36.8x12.7	6
WBA300	180~375V	3.3~48V	264~600W	Supported	Isolated, Regulated	116.8x55.9x12.7	7
WBC375	250~425V	3.3~48V	75~150W	Supported	Isolated, Regulated	57.9x36.8x12.7	8
WBB375	250~425V	3.3~48V	150~300W	Supported	Isolated, Regulated	57.9x55.9x12.7	9
WBA375	250~425V	3.3~48V	264~600W	Supported	Isolated, Regulated	116.8x55.9x12.7	10
WBM-FIAM	180~375V	180~375V	600W	Not supported	Input Attenuator	57.9x55.9x12.7	11
WB $\mu$ RAM	3~30V	3~30V	60~900W	Supported	Ripple attenuator	57.9x36.8x12.7	12
WBVI-ARM	180~264Vac	200~375VDC	750W	Not supported	Rectifier filter	57.9x36.8x12.7	13

## WBC24 Series Quarter Brick DC-DC Converter

### Features

- Isolated, regulated
- Pin-to-Pin compatible with VICOR V24C series
- Input surge resistance: 50V/100ms
- Output adjustment range: 75% ~ 110%
- Over-voltage, under-voltage, over-current, short-circuit and thermal protections
- Supports 6 parallel expansion (without ORING)
- 3000Vac isolation
- Operating temperature: -55°C ~ 100°C (non-derating)
- Quarter brick standard package: 57.9 × 36.8 × 12.7 mm
- Comply with GJB10164-2021



### Product Specification

Product Module	Input Voltage	Output Voltage	Adjustable Range	Output Current	Output Power	Efficiency
WBC75-24x3V3BN	18~40V	3.3V	75%~110%	22.72A	75W	88.5%
WBC125-24x5BN	18~40V	5V	75%~110%	25A	125W	90.5%
WBC125-24x8BN	18~40V	8V	75%~110%	15.7A	125W	91.0%
WBC150-24x12BN	18~40V	12V	75%~110%	12.5A	150W	91.0%
WBC150-24x15BN	18~40V	15V	75%~110%	10A	150W	92.0%
WBC150-24x24BN	18~40V	24V	75%~110%	6.3A	150W	88.5%
WBC150-24x28BN	18~40V	28V	75%~110%	5.4A	150W	89.5%
WBC150-24x36BN	18~40V	36V	75%~110%	4.17A	150W	88.0%
WBC150-24x48BN	18~40V	48V	75%~110%	3.1A	150W	89.5%

### Shape & Size

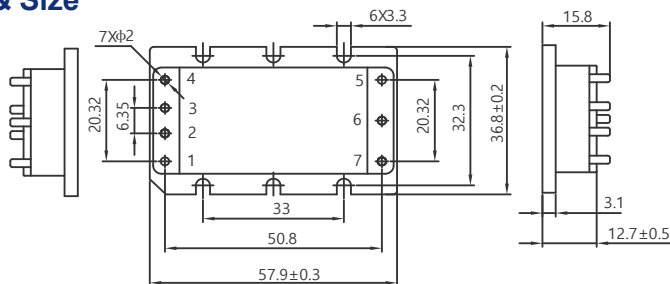

Pin No.	Label	Function
1	+IN	Positive input power terminal
2	PC	Primary side control
3	PR	Parallel terminal
4	-IN	Negative input power terminal
5	-OUT	Negative output power terminal
6	SC	Secondary side control terminal
7	+OUT	Positive output power terminal

### Part Numbering

WB	C	75	-	24	x	12	BN
Brand Category	Package	Output Power	-	Input Voltage	Temperature Grade	Output Voltage	Version
Wibbow B Category	C: Quarter Brick	75: 75W 125: 125W 150: 150W		24: 18~40V	M: Tc: -55~100°C Ts: -65~125°C H: Tc: -40~100°C Ts: -55~125°C T: Tc: -40~100°C Ts: -40~125°C	3V3: 3.3V 5: 5V 8: 8V 12: 12V 15: 15V 24: 24V 28: 28V 36: 36V 48: 48V	BN: Long Module Mate (Gold)



## WBB24 Series Half Brick DC-DC Converter

### Features

- Isolated, regulated
- Pin-to-Pin compatible with VICOR V24B series
- Input surge resistance: 50V/100ms
- Output adjustment range: 75% ~ 110%
- Over-voltage, under-voltage, over-current, short-circuit and thermal protections
- Supports 6 parallel expansion (without ORING)
- 3000Vac isolation
- Operating temperature: -55°C ~ 100°C (non-derating)
- Half brick standard package: 57.9 × 55.9 × 12.7 mm
- Comply with GJB10164-2021



### Product Specification

Product Module	Input Voltage	Output Voltage	Adjustable Range	Output Current	Output Power	Efficiency
WBB150-24x3V3BN	18~40V	3.3V	75%~110%	45.5A	150W	88.2%
WBB200-24x5BN	18~40V	5V	75%~110%	40A	200W	88.5%
WBB250-24x12BN	18~40V	12V	75%~110%	20.8A	250W	91.5%
WBB250-24x15BN	18~40V	15V	75%~110%	16.7A	250W	91.0%
WBB250-24x24BN	18~40V	24V	75%~110%	10.4A	250W	91.1%
WBB250-24x28BN	18~40V	28V	75%~110%	8.9A	250W	90.5%
WBB250-24x36BN	18~40V	36V	75%~110%	6.9A	250W	90.0%
WBB250-24x48BN	18~40V	48V	75%~110%	5.2A	250W	89.1%

### Shape & Size

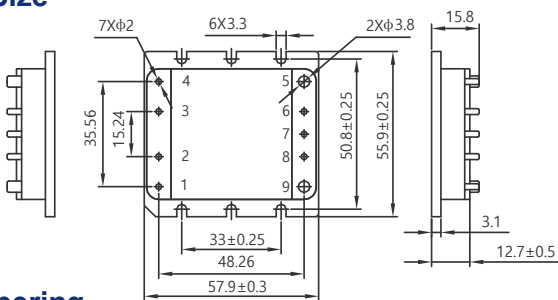

Pin No.	Label	Function
1	+IN	Positive input power terminal
2	PC	Primary side control
3	PR	Parallel terminal
4	-IN	Negative input power terminal
5	-OUT	Negative output power terminal
6	-S	Distal compensation negative terminal
7	SC	Secondary side control terminal
8	+S	Distal compensation positive terminal
9	+OUT	Positive output power terminal

### Part Numbering

WB	B	150	-	24	x	3V3	BN
Brand Category	Package	Output Power	-	Input Voltage	Temperature Grade	Output Voltage	Version
Wibbow B Category	B: Half Brick	150: 200W 200: 200W 250: 250W		24: 18~40V	M: Tc: -55~100°C Ts: -65~125°C H: Tc: -40~100°C Ts: -55~125°C T: Tc: -40~100°C Ts: -40~125°C	3V3: 3.3V 5: 5V 8: 8V 12: 12V 15: 15V 24: 24V 28: 28V 36: 36V 48: 48V	BN: Long Module Mate (Gold)

## WBA24 Series Full Brick DC-DC Converter

### Features

- Isolated, regulated
- Pin-to-Pin compatible with VICOR V24A series
- Input surge resistance: 50V/100ms
- Output adjustment range: 75% ~ 110%
- Over-voltage, under-voltage, over-current, short-circuit and thermal protections
- Supports 6 parallel expansion (without ORING)
- 3000Vac isolation
- Operating temperature: -55°C ~ 100°C (non-derating)
- Full brick standard package: 116.8 × 55.9 × 12.7 mm
- Comply with GJB10164-2021



### Product Specification

Product Module	Input Voltage	Output Voltage	Adjustable Range	Output Current	Output Power	Efficiency
WBA400-24x5BN	18~40V	5V	75%~110%	80A	400W	88.5%
WBA400-24x12BN	18~40V	12V	75%~110%	33.4A	400W	91.5%
WBA500-24x28BN	18~40V	28V	75%~110%	17.9A	500W	90.5%

### Shape & Size

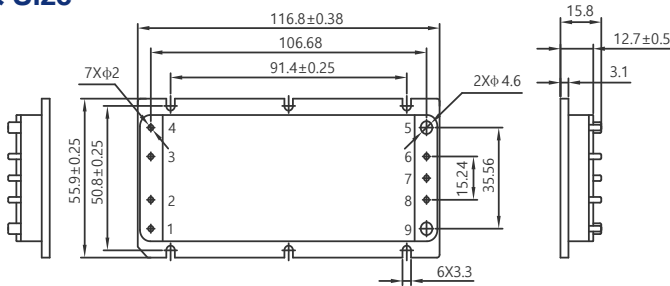

Pin No.	Label	Function
1	+IN	Positive input power terminal
2	PC	Primary side control
3	PR	Parallel terminal
4	-IN	Negative input power terminal
5	-OUT	Negative output power terminal
6	-S	Distal compensation negative terminal
7	SC	Secondary side control terminal
8	+S	Distal compensation positive terminal
9	+OUT	Positive output power terminal

### Part Numbering

WB	A	300	-	24	x	3V3	BN
Brand Category	Package	Output Power	-	Input Voltage	Temperature Grade	Output Voltage	Version
Wibbow B Category	A: Full Brick	300: 300W 400: 400W 500: 500W		24: 18~40V	M: Tc: -55~100°C Ts: -65~125°C H: Tc: -40~100°C Ts: -55~125°C T: Tc: -40~100°C Ts: -40~125°C	3V3: 3.3V 24: 24V 5: 5V 28: 28V 8: 8V 36: 36V 12: 12V 48: 48V 15: 15V	BN: Long Module Mate (Gold)

## WBC300 Series Quarter Brick DC-DC Converter

### Features

- Isolated, regulated
- Variable frequency control, mixed insertion with VICOR V300C series
- Input surge resistance: 400V/100ms
- Wide output adjustment range: 75% ~ 110%
- About 5% higher efficiency than similar VICOR products
- Over-voltage, under-voltage, over-current, short-circuit and thermal protections
- Supports 6 parallel expansion (without ORING);
- 3000Vac isolation
- Operating temperature: -55°C ~ 100°C (non-derating)
- Quarter brick standard package: 57.9 x 36.8 x 12.7 mm
- Comply with GJB10164-2021

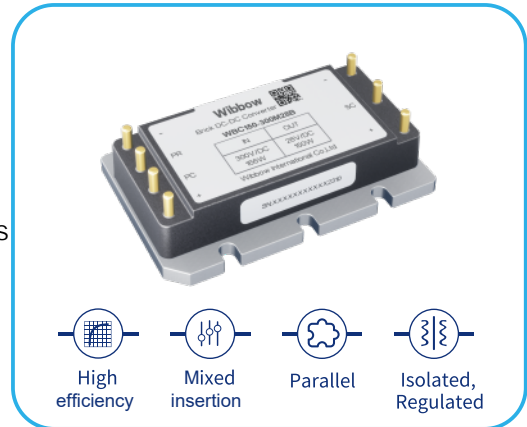

### Product Specification

Product Module	Input voltage	Output voltage	Adjustable Range	Output Current	Output Power	Efficiency
WBC75-300x3V3BN	180~375V	3.3V	75%~110%	22.72A	75W	85.5%
WBC100-300x5BN	180~375V	5V	75%~110%	20A	100W	88.5%
WBC100-300x8BN	180~375V	8V	75%~110%	12.5A	100W	88.0%
WBC150-300x12BN	180~375V	12V	75%~110%	12.5A	150W	89.0%
WBC150-300x15BN	180~375V	15V	75%~110%	10A	150W	90.2%
WBC150-300x24BN	180~375V	24V	75%~110%	6.25A	150W	89.5%
WBC200-300x24BN	180~375V	24V	75%~110%	8.33A	200W	90.5%
WBC150-300x28BN	180~375V	28V	75%~110%	5.36A	150W	89.5%
WBC150-300x36BN	180~375V	36V	75%~110%	4.17A	150W	89.5%
WBC150-300x48BN	180~375V	48V	75%~110%	3.13A	150W	90.5%

### Shape & Size

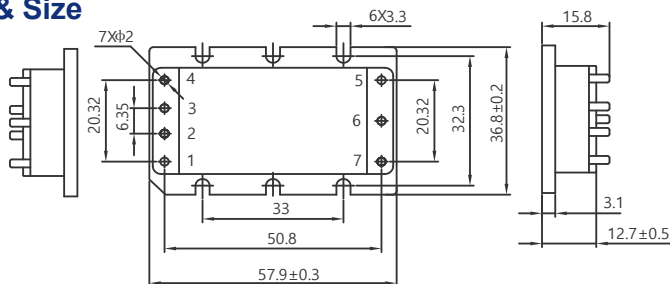

Pin No.	Label	Function
1	+IN	Positive input power terminal
2	PC	Primary side control
3	PR	Parallel terminal
4	-IN	Negative input power terminal
5	-OUT	Negative output power terminal
6	SC	Secondary side control terminal
7	+OUT	Positive output power terminal

### Part Numbering

WB	C	75	-	300	x	3V3	BN
Brand Category	Package	Output Power	-	Input Voltage	Temperature Grade	Output Voltage	Version
Wibbow B Category	C: Quarter Brick	75: 75W 100: 100W 150: 150W 200: 200W		300: 180~375V	M : Tc: -55~100°C Ts: -65~125°C H : Tc: -40~100°C Ts: -55~125°C T : Tc: -40~100°C Ts: -40~125°C	3V3: 3.3V 5: 5V 8: 8V 12: 12V 15: 15V 24: 24V 28: 28V 36: 36V 48: 48V	BN: Long Module Mate (Gold)

## WBB300 Series Half Brick DC-DC Converter

### Features

- Isolated, regulated
- Variable frequency control, mixed insertion with VICOR V300B series
- Input surge resistance: 400V/100ms
- Wide output adjustment range: 75% ~ 110%
- About 5% higher efficiency than similar VICOR products
- Over-voltage, under-voltage, over-current, short-circuit and thermal protections
- Supports 6 parallel expansion (without ORING)
- 3000Vac isolation
- Operating temperature: -55°C ~ 100°C (non-derating)
- Half brick standard package: 57.9 × 55.9 × 12.7 mm
- Comply with GJB10164-2021

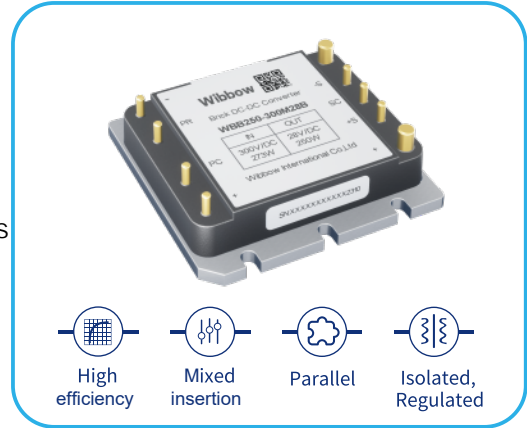

### Product Specification

Product Module	Input Voltage	Output Voltage	Adjustable Range	Output Current	Output Power	Efficiency
WBB150-300x3V3BN	180~375V	3.3V	75%~110%	45.4A	150W	84.5%
WBB200-300x5BN	180~375V	5V	75%~110%	40A	200W	88.5%
WBB220-300x5V5BN	180~375V	5.5V	75%~110%	40A	220W	89.0%
WBB200-300x8BN	180~375V	8V	75%~110%	25A	200W	90.5%
WBB250-300x12BN	180~375V	12V	75%~110%	20.8A	250W	90.5%
WBB250-300x15BN	180~375V	15V	75%~110%	16.7A	250W	91.3%
WBB250-300x24BN	180~375V	24V	75%~110%	10.4A	250W	91.0%
WBB250-300x28BN	180~375V	28V	75%~110%	8.9A	250W	90.5%
WBB250-300x36BN	180~375V	36V	75%~110%	6.9A	250W	89.5%
WBB250-300x48BN	180~375V	48V	75%~110%	5.2A	250W	89.5%

### Shape & Size

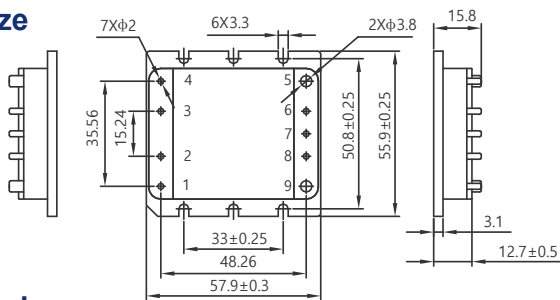

Pin No.	Label	Function
1	+IN	Positive input power terminal
2	PC	Primary side control
3	PR	Parallel terminal
4	-IN	Negative input power terminal
5	-OUT	Negative output power terminal
6	-S	Distal compensation negative terminal
7	SC	Secondary side control terminal
8	+S	Distal compensation positive terminal
9	+OUT	Positive output power terminal

### Part Numbering

WB	B	150	-	300	x	3V3	BN
Brand Category	Package	Output Power	-	Input Voltage	Temperature Grade	Output Voltage	Version
Wibbow B Category	B: Half Brick	150: 150W 200: 200W 220: 220W 250: 250W		300: 180~375V	M: T <sub>c</sub> : -55~100°C T <sub>s</sub> : -65~125°C H: T <sub>c</sub> : -40~100°C T <sub>s</sub> : -55~125°C T: T <sub>c</sub> : -40~100°C T <sub>s</sub> : -40~125°C	3V3: 3.3V 5: 5V 5V5: 5.5V 8: 8V 12: 12V 15: 15V 24: 24V 28: 28V 36: 36V 48: 48V	BN: Long Module Mate (Gold)

## WBA300 Series Full Brick DC-DC Converter

### Features

- Isolated, regulated
- Variable frequency control, mixed insertion with VICOR V300A series
- Input surge resistance: 400V/100ms
- Wide output adjustment range: 75% ~ 110%
- About 5% higher efficiency than similar VICOR products
- Over-voltage, under-voltage, over-current, short-circuit and thermal protections
- Supports 6 parallel expansion (without ORING)
- 3000Vac isolation
- Operating temperature: -55°C ~ 100°C (non-derating)
- Full brick standard package: 116.8 × 55.9 × 12.7 mm
- Comply with GJB10164-2021

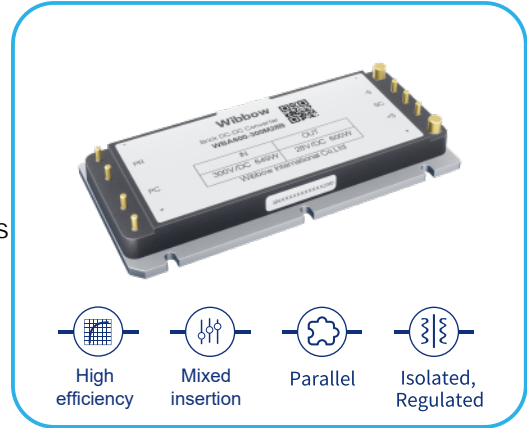

### Product Specification

Product Module	Input Voltage	Output Voltage	Adjustable Range	Output Current	Output Power	Efficiency
WBA264-300x3V3BN	180~375V	3.3V	75%~110%	80A	264W	87.5%
WBA400-300x5BN	180~375V	5V	75%~110%	80A	400W	90.5%
WBA400-300x8BN	180~375V	8V	75%~110%	50A	400W	91.0%
WBA550-300x9BN	180~375V	9V	75%~110%	61.1A	550W	91.5%
WBA600-300x12BN	180~375V	12V	75%~110%	50A	600W	92.0%
WBA600-300x15BN	180~375V	15V	75%~110%	40A	600W	92.5%
WBA600-300x24BN	180~375V	24V	75%~110%	25A	600W	92.5%
WBA600-300x28BN	180~375V	28V	75%~110%	21.5A	600W	92.0%
WBA600-300x36BN	180~375V	36V	75%~110%	16.7A	600W	92.0%
WBA600-300x48BN	180~375V	48V	75%~110%	12.5A	600W	92.0%

### Shape & Size

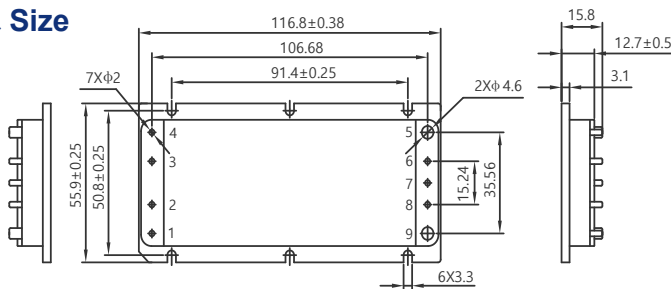

Pin No.	Label	Function
1	+IN	Positive input power terminal
2	PC	Primary side control
3	PR	Parallel terminal
4	-IN	Negative input power terminal
5	-OUT	Negative output power terminal
6	-S	Distal compensation negative terminal
7	SC	Secondary side control terminal
8	+S	Distal compensation positive terminal
9	+OUT	Positive output power terminal

### Part Numbering

WB	A	264	-	300	x	3V3	BN
Brand Category	Package	Output Power	-	Input Voltage	Temperature Grade	Output Voltage	Version
Wibbow B Category	A: Full Brick	264: 264W 400: 400W 550: 550W 600: 600W		300: 180~375V	M : T <sub>c</sub> : -55~100°C T <sub>s</sub> : -65~125°C H : T <sub>c</sub> : -40~100°C T <sub>s</sub> : -55~125°C T : T <sub>c</sub> : -40~100°C T <sub>s</sub> : -40~125°C	3V3: 3.3V 15: 15V 5: 5V 24: 24V 8: 8V 28: 28V 9: 9V 36: 36V 12: 12V 48: 48V	BN: Long Module Mate (Gold)

## WBC375 Series Quarter Brick DC-DC Converter

### Features

- Isolated, regulated
- Variable frequency control, mixed insertion with VICOR V375C series
- Input surge resistance: 500V/100ms
- Wide-output voltage regulation range: 75% ~ 110%
- About 5% higher efficiency than similar VICOR products
- Over-voltage, under-voltage, over-current, short-circuit and thermal protections
- Supports 6 parallel expansion (without ORING)
- 3000Vac isolation
- Operating temperature: -55°C ~ 100°C (non-derating)
- Quarter brick standard package: 57.9 × 36.8 × 12.7 mm
- Comply with GJB10164-2021

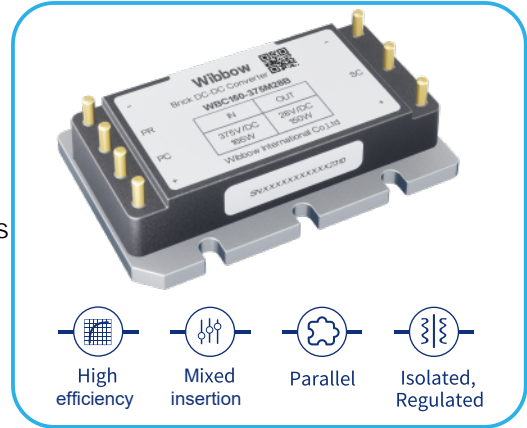

### Product Specification

Product Module	Input Voltage	Output Voltage	Adjustable Range	Output Current	Output Power	Efficiency
WBC75-375x3V3BN	250~425V	3.3V	75%~110%	22.7A	75W	86.0%
WBC100-375x5BN	250~425V	5V	75%~110%	20A	100W	88.5%
WBC100-375x8BN	250~425V	8V	75%~110%	12.5A	100W	89.0%
WBC150-375x12BN	250~425V	12V	75%~110%	12.5A	150W	89.0%
WBC150-375x15BN	250~425V	15V	75%~110%	10A	150W	90.2%
WBC150-375x24BN	250~425V	24V	75%~110%	6.25A	150W	89.7%
WBC150-375x28BN	250~425V	28V	75%~110%	5.36A	150W	90.0%
WBC150-375x36BN	250~425V	36V	75%~110%	4.17A	150W	89.7%
WBC150-375x48BN	250~425V	48V	75%~110%	3.13A	150W	89.0%

### Shape & Size

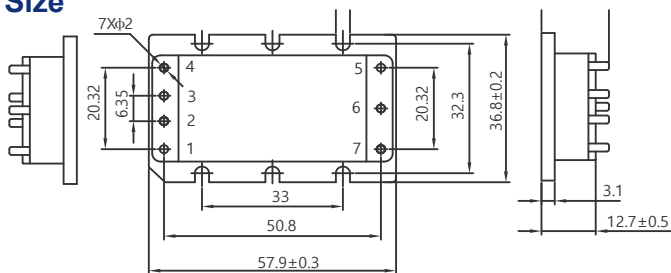

Pin No.	Label	Function
1	+IN	Positive input power terminal
2	PC	Primary side control
3	PR	Parallel terminal
4	-IN	Negative input power terminal
5	-OUT	Negative output power terminal
6	SC	Secondary side control terminal
7	+OUT	Positive output power terminal

### Part Numbering

WB	C	75	-	375	x	3V3	BN
Brand Category	Package	Output Power	-	Input Voltage	Temperature Grade	Output Voltage	Version
Wibbow B Category	C: Quarter Brick	75: 75W 100: 100W 150: 150W		375: 250~425V	M: T: -55~100°C Ts: -65~125°C H: T: -40~100°C Ts: -55~125°C T: Tc: -40~100°C T: -40~125°C	3V3: 3.3V 5: 5V 8: 8V 12: 12V 15: 15V 24: 24V 28: 28V 36: 36V 48: 48V	BN: Long Module Mate (Gold)

## WBB375 Series Half Brick DC-DC Converter

### Features

- Isolated, regulated
- Variable frequency control, mixed insertion with VICOR V375B series
- Input surge resistance: 500V/100ms
- Wide output adjustment range: 75% ~ 110%
- About 5% higher efficiency than similar VICOR products
- Over-voltage, under-voltage, over-current, short-circuit and thermal protections
- Supports 6 parallel expansion (without ORING)
- 3000Vac isolation of primary and secondary sides
- Operating temperature: -55°C ~ 100°C (non-derating)
- Half brick standard package: 57.9 × 55.9 × 12.7 mm
- Comply with GJB10164-2021

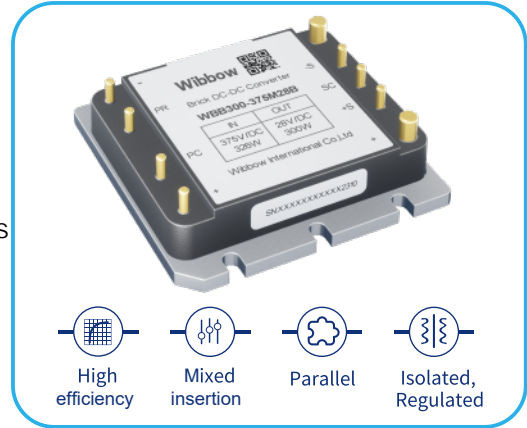

### Product Specification

Product Module	Input Voltage	Output Voltage	Adjustable Range	Output Current	Output Power	Efficiency
WBB150-375x3V3BN	250~425V	3.3V	75%~110%	45.45A	150W	84.5%
WBB200-375x5BN	250~425V	5V	75%~110%	40A	200W	88.5%
WBB200-375x8BN	250~425V	8V	75%~110%	25A	200W	90.5%
WBB300-375x12BN	250~425V	12V	75%~110%	25A	300W	90.0%
WBB300-375x15BN	250~425V	15V	75%~110%	20A	300W	90.5%
WBB300-375x24BN	250~425V	24V	75%~110%	12.5A	300W	91.0%
WBB300-375x28BN	250~425V	28V	75%~110%	10.71A	300W	91.5%
WBB300-375x36BN	250~425V	36V	75%~110%	8.33A	300W	91.0%
WBB300-375x48BN	250~425V	48V	75%~110%	6.25A	300W	91.0%

### Shape & Size

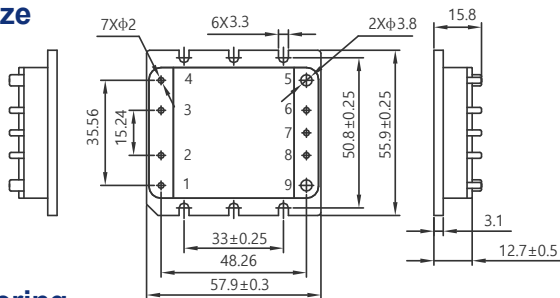

Pin No.	Label	Function
1	+IN	Positive input power terminal
2	PC	Primary side control
3	PR	Parallel terminal
4	-IN	Negative input power terminal
5	-OUT	Negative output power terminal
6	-S	Distal compensation negative terminal
7	SC	Secondary side control terminal
8	+S	Distal compensation positive terminal
9	+OUT	Positive output power terminal

### Part Numbering

WB	B	150	-	375	x	3V3	BN
Brand Category	Package	Output Power	-	Input Voltage	Temperature Grade	Output Voltage	Version
Wibbow B Category	B: Half Brick	150: 150W 200: 200W 300: 300W		375: 250~425V	M : Tc: -55~100°C Ts: -65~125°C H : Tc: -40~100°C Ts: -55~125°C T : Tc: -40~100°C T: -40~125°C	3V3: 3.3V 5: 5V 8: 8V 12: 12V 15: 15V 24: 24V 28: 28V 36: 36V 48: 48V	BN: Long Module Mate (Gold)

## WBA375 Series Full Brick DC-DC Converter

### Features

- Isolated, regulated
- Variable frequency control, mixed insertion with VICOR V375A series
- Input surge resistance: 500V/100ms
- Wide-output voltage regulation range: 75% ~ 110%
- About 5% higher efficiency than similar VICOR products
- Over-voltage, under-voltage, over-current, short-circuit and thermal protections
- Supports 6 parallel expansion (without ORING)
- 3000Vac isolation
- Operating temperature: -55°C ~ 100°C (non-derating)
- Full brick standard package: 116.8 × 55.9 × 12.7 mm
- Comply with GJB10164-2021

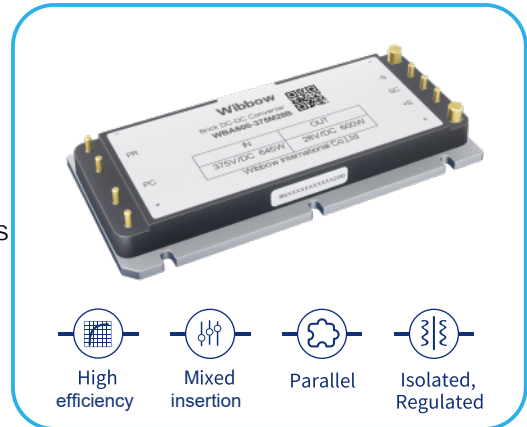

### Product Specification

Product Module	Input Voltage	Output Voltage	Adjustable Range	Output Current	Output Power	Efficiency
WBA264-375x3V3BN	250~425V	3.3V	75%~110%	80A	264W	86.5%
WBA400-375x5BN	250~425V	5V	75%~110%	80A	400W	89.5%
WBA400-375x8BN	250~425V	8V	75%~110%	50A	400W	91.0%
WBA600-375x12BN	250~425V	12V	75%~110%	50A	600W	92.5%
WBA600-375x15BN	250~425V	15V	75%~110%	40A	600W	92.5%
WBA600-375x24BN	250~425V	24V	75%~110%	25A	600W	92.5%
WBA600-375x28BN	250~425V	28V	75%~110%	21.5A	600W	92.5%
WBA600-375x36BN	250~425V	36V	75%~110%	16.7A	600W	92.5%
WBA600-375x48BN	250~425V	48V	75%~110%	12.5A	600W	92.5%

### Shape & Size

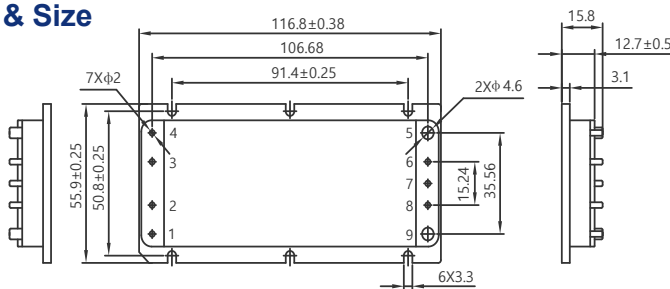

Pin No.	Label	Function
1	+IN	Positive input power terminal
2	PC	Primary side control
3	PR	Parallel terminal
4	-IN	Negative input power terminal
5	-OUT	Negative output power terminal
6	-S	Distal compensation negative terminal
7	SC	Secondary side control terminal
8	+S	Distal compensation positive terminal
9	+OUT	Positive output power terminal

### Part Numbering

WB	A	264	-	375	x	3V3	BN
Brand Category	Package	Output Power	-	Input Voltage	Temperature Grade	Output Voltage	Version
Wibbow B Category	A: Full Brick	264: 264W 400: 400W 600: 600W		375: 250~425V	M: T <sub>c</sub> : -55~100°C T <sub>s</sub> : -65~125°C H: T <sub>c</sub> : -40~100°C T <sub>s</sub> : -55~125°C T: T <sub>c</sub> : -40~100°C T: -40~125°C	3V3: 3.3V 5: 5V 8: 8V 12: 12V 15: 15V 24: 24V 28: 28V 36: 36V 48: 48V	BN: Long Module Mate (Gold)



## WBM-FIAM Series EMI Input Attenuator Module

### Features

- Wide input voltage range: 180 ~ 375V
- Pin-to-Pin compatible with VICOR M-FIAM series
- High input surge: 400V/100ms
- Comply with the EMC standards such as CE101 and CE102
- EM filter, transient protection, surge current suppression
- Match WBx300 series
- Operating temperature: -55°C ~ 100°C (non-derating)
- Half brick standard package: 57.9 × 55.9 × 12.7 mm
- Comply with GJB10164-2021



### Product Specification

Product Module	Input Voltage	Internal Voltage Drop	Output Current	EMC	Efficiency
WBM-FIAM3x21	180-375V	5V	3A	CE101/CE102	98%
WBM-FIAM9x21	12-36V	1.5V	18V	CE101/CE102	98%

### Shape & Size

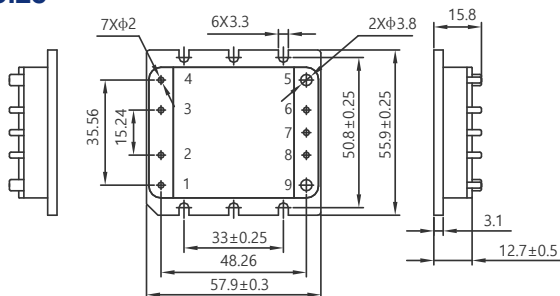

Pin No.	Label	Function
1	+IN	Positive input power terminal
2	NC	NULL
3	GND	EMI/GND
4	-IN	Negative input power terminal
5	-OUT	Negative output power terminal
6	ON/OFF	Control switch
7	NC	NULL
8	NC	NULL
9	+OUT	Positive output power terminal

### Part Numbering

WB	M-FIAM	3	x	2	1
Brand Category	Series Name	Output Current	Temperature Grade	Pin Style	Baseplate
Wibbow B Category	EMI Input Attenuator	3: 3A 9: 9A	M : T <sub>c</sub> : -55~100°C T <sub>s</sub> : -65~125°C H: T <sub>c</sub> : -40~100°C T <sub>s</sub> : -55~125°C T: T <sub>c</sub> : -40~100°C T: -40~125°C	2: Long pin	1: Slotted

## WB $\mu$ RAM Series Ripple attenuator module

### Features

- Wide input voltage range: 3V ~ 30V
- High efficiency: 98%
- Output ripple:  $\leq 10\text{mV}$
- High-frequency ripple attenuation:  $> 40\text{dB}$  (1.1kHz-1MHz)
- Low-frequency ripple attenuation:  $> 40\text{dB}$  (100Hz-1.1kHz)
- Pin-to-Pin compatible with VICOR  $\mu$ RAM series
- Parallel expansion (reverse current protection)
- Match Wibbow WBx300, WBx375 series
- Operating temperature:  $-55^{\circ}\text{C} \sim 100^{\circ}\text{C}$  (non-derating)
- Quarter brick standard package:  $57.9 \times 36.8 \times 12.7 \text{ mm}$
- Comply with GJB10164-2021

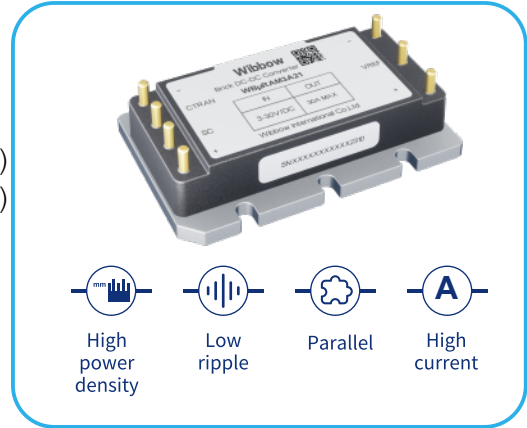

### Product Specification

Product Module	Input Voltage	Output Ripple	Differential Pressure	Output Current	Transient Response	Efficiency
WB $\mu$ RAM2x21	3~30V	10mV	425mV	20A	50mV <sub>p-p</sub>	98%
WB $\mu$ RAM3x21	3~30V	10mV	425mV	30A	50mV <sub>p-p</sub>	98%
WB $\mu$ RAM4x21	3~30V	10mV	425mV	40A	50mV <sub>p-p</sub>	98%

### Shape & Size

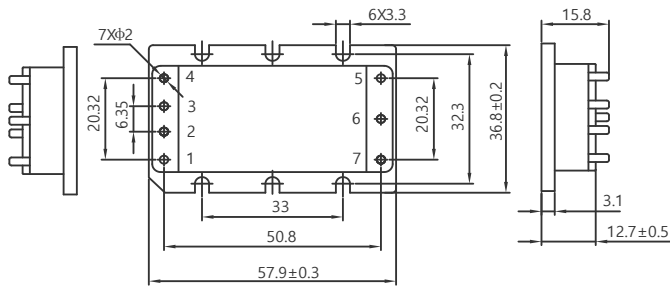

Pin No.	Label	Function
1	+IN	Positive input power terminal
2	PC	Primary side control
3	CTRAIN	External capacitor terminal
4	-IN	Negative input power terminal
5	-OUT	Negative output power terminal
6	VREF	Secondary side control
7	+OUT	Positive output power terminal

### Part Numbering

WB	$\mu$ RAM	2	x	2	1
Brand Category	Series Name	Output Current	Temperature Grade	Pin Style	Baseplate
Wibbow B Category	Ripple attenuator	2: 20A 3: 30A	M : $T_c: -55 \sim 100^{\circ}\text{C}$ $T_s: -65 \sim 125^{\circ}\text{C}$ H : $T_c: -40 \sim 100^{\circ}\text{C}$ $T_s: -55 \sim 125^{\circ}\text{C}$ T : $T_c: -40 \sim 100^{\circ}\text{C}$ $T: -40 \sim 125^{\circ}\text{C}$	2: Long pin	1: Slotted

## WBVI-ARM Series Autoranging Rectifier Module

### Features

- Wide AC input range: 180Vac ~ 264Vac
- High input surge voltage: 280Vac/100ms
- Input surge current  $\leq 30A$
- Pin-to-Pin compatible with VICOR VI-ARM series
- Normal DC output indication function
- Match Wibbow WBx300 series
- Isolation: input/output to substrate  $\geq 1500$  VRMS
- Operating temperature:  $-40^{\circ}C \sim 100^{\circ}C$  (non-derating)
- Quarter brick standard package:  $57.9 \times 36.8 \times 12.7$  mm
- Comply with GJB10164-2021



### Product Specification

Product Module	Input Voltage	Output Voltage	Input Frequency	Input surge withstand	Output power	Efficiency
WBVI-ARM-x12	180~264Vac	235~375Vdc	47-63Hz	280Vac/100ms	750W	96%
WBVI-ARM-x22	180~264Vac	235~375Vdc	47-63Hz	280Vac/100ms	1000W	96%

### Shape & Size

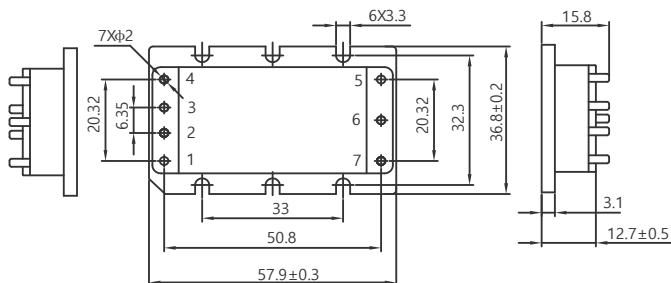

Pin No.	Label	Function
1	-V	-OUT
2	EN	Enables and disables power supply
3	B OK	Normal bus voltage indication
4	+V	+OUT
5	N	N-phase
6	ST	NULL
7	L	L-phase

### Part Numbering

WB	VI-ARM	-	x	1	2
Brand Category	Series Name	-	Temperature Grade	Output Power	Pin Style
Wibbow B Category	Autoranging rectifier		H: $T_c: -40 \sim 100^{\circ}C$ $T_s: -55 \sim 125^{\circ}C$ T: $T_c: -40 \sim 100^{\circ}C$ $T: -40 \sim 125^{\circ}C$	1: 750W 2: 1000W	2: Long pin



# Wibbow

Tel: +86-571-56058860

Email: [info@wibbow.com](mailto:info@wibbow.com)

Website: [www.wibbow.com](http://www.wibbow.com)

ADD: Room 908, Hiwell World T4, No. 475 Qizhi Street, Binjiang District,  
Hangzhou City, Zhejiang Province, China